

Bourdon tube pressure gauge

H 043

thermo **bau**

BIMETALL-MESSTECHNIK



For heating / sanitary applications - with self-sealing thread

For closed heating systems.

Nominal size:	50 – 63 – 80 – 100 mm
Connection:	Brass, back or bottom NG 50 – 63 mm: G $\frac{1}{4}$ " – SW 14 NG 80 – 100 mm: G $\frac{1}{2}$ " – SW 22
Housing:	ABS black, impact-resistant and corrosion-resistant
Window:	Clip in plastic; with adjustable red pointer and green sector (NG 80 – 100 mm)
Movement:	Brass
Pointer:	Plastic, black
Dial:	White, with red mark at 3 bar and green sector from 1.5 to 3 bar
Measuring element:	Bourdon tube element, copper alloy, "C" type bourdon tube
Measuring range: (EN 837-1/5)	0/4 bar
Accuracy: (EN 837-3/6)	NG 50 – 80 mm : class 2,5 / NG 100 mm: class 1,6
Range of application:	Static load: $\frac{3}{4}$ x scale value Alternating load: $\frac{2}{3}$ x scale value Short-time: full scale value
Operating temperature:	Environment: $T_{min} = -20^{\circ}C$ $T_{max} = +60^{\circ}C$ Medium: $T_{max} = +60^{\circ}C$
Temperature error:	Indication error when the temperature of the measuring Element deviates from +20°C: rising or falling temperature approx. $\pm 0,4\%/10$ K percentage of full scale value
Protection:	IP 32 (EN 60529)
Options:	Normal standard version Other measuring ranges Hydrometer NG 100 – water level indicator for standard heating systems

HZ 50 – back connection (lower)

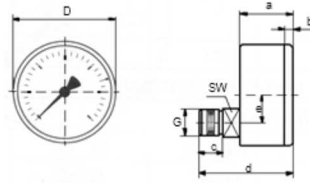

RF / HZ 63 – bottom connection

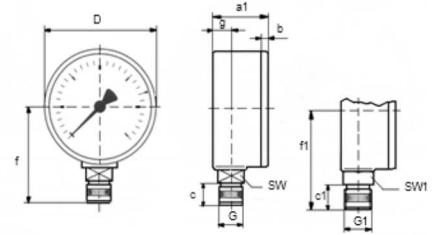

RF / HZ 63 – back connection (centre)

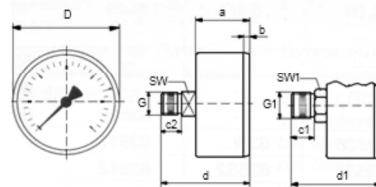

RF / HZ 80 – bottom connection

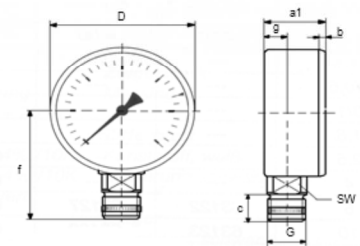

RF / HZ 80 back connection (centre)

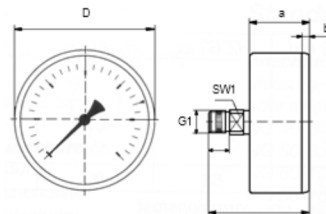

We can offer further versions and special remarks on request.

NG	a	a1	b	c	c1	c2	d	d1	e
50	25,8	-	3,8	11,2	-	-	43	-	14
63	30,4	29,7	3,7	11,2	13	11,5	49,9	50,4	-
80	32,8	32,8	2,8	17	11,5	-	55,8	-	-
NG	f	f1	g	D	G*	G1*	SW	SW1	
50	-	-	-	50	G1/4B	-	14	-	
63	40	51,5	9,8	63	G1/4B	G3/8B	14	17	
80	68	-	12,8	80	G1/2B	G1/4B	22	14	

- Attention: ca. 60° chamfer required are female thread

Details

We can offer further versions and special remarks on request.

[Technical changes reserve.](#)



Thermobau Wirthwein KG
 Walter-Wirthwein-Straße 12
 D-97993 Creglingen
 Tel: +49 (0) 7933 9900-30
 Fax: +49 (0) 7933 9900-32
 www.thermobau-wirthwein.de
 mail@thermobau-wirthwein.de